

Вложка 1/2" IMPACT - 231/4 6p

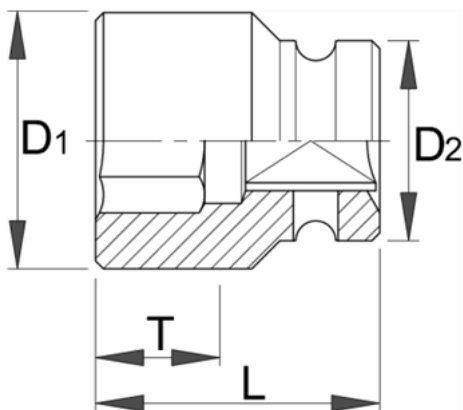

Описание





- материал: хром-молибден
- ковани, изцяло закалени
- фосфатирани в съответствие със стандарт DIN 12476
- изработена в съответствие със стандарт ISO 2725-2 (само за метрични размери)

Технически параметри

Barcode	Hex	D1	D2	L	T	Weight	Material	Finish
603962	10	17.5	25	38	12	94	4B	5
603963	11	18.7	25	38	12	95	4B	5
603964	12	20	25	38	12	95	4B	5
603965	13	21.3	25	38	12	96	4B	5
603966	14	22.5	25	38	12	95	4B	5
603967	15	23.7	30	38	12	140	4B	5
603968	16	25	30	38	12	143	4B	5
603969	17	26.2	30	38	13	140	4B	5
609399	18	27.5	30	38	13	135	4B	5
603970	19	28.7	30	38	13	126	4B	5
603971	21	30	30	38	13	139	4B	5
603972	22	32	30	38	13	133	4B	5
603973	23	32	30	38	13	183	4B	5
603974	24	35	30	45	20	235	4B	5
603975	27	38.7	30	50	24	235	4B	5
609400	28	40	30	50	24	255	4B	5
603976	30	42	30	50	24	259	4B	5
605548	32	42	30	50	24	72	4B	5
618709	5/16"	15	22	38	9	72	4B	1
618710	3/8"	16	22	38	12	72	4B	1
618711	7/16"	18	22	38	12	72	4B	1
618712	1/2"	20	22	38	12	69	4B	1
618713	9/16"	22	24	38	12	83	4B	1
618714	5/8"	25	25	38	12	89	4B	1
618715	11/16"	26	26	38	13	95	4B	1
618716	3/4"	28	28	38	13	108	4B	1
618717	13/16"	30	30	38	14	129	4B	1
618718	7/8"	32	32	38	15	145	4B	1
618719	15/16"	34	34	38	13	165	4B	1
618720	1"	36	36	38	14	183	4B	1
618721	1.1/16"	38	38	40	17	215	4B	1
618722	1.1/8"	40	38	40	17	226	4B	1
618723	1.3/16"	42	38	40	17	241	4B	1
618724	1.1/4"	44	38	40	17	248	4B	1
618725	1.5/16"	45	38	43	19	276	1E	1
618726	1.3/8"	48.5	38	50	24	333	1E	1
618727	1.7/16"	50.5	38	50	24	374	1E	1
618728	1.1/2"	52.5	38	50	24	376	1E	1

Информация за опаковането

Barcode	Hex	Опаковка за търговия на дребно				Транспортна опаковка				
		A	Б	Ц	Weight	A1	Б1	Ц1	Weight	
603962	10	105	44	43	99	4	93	144	57	521
603963	11	105	44	43	100	4	93	144	57	525
603964	12	105	44	43	100	4	93	144	57	525
603965	13	105	44	43	101	4	93	144	57	529
603966	14	105	44	43	100	4	93	144	57	525
603967	15	105	44	44	145	4	93	144	57	705
603968	16	105	44	44	148	4	93	144	57	717
603969	17	105	44	44	145	4	93	144	57	705
609399	18	105	44	44	140	4	93	144	57	685
603970	19	105	44	44	131	4	93	144	57	649
603971	21	105	44	44	144	4	93	144	57	701
603972	22	105	44	45	138	4	93	144	57	677
603973	23	105	44	45	188	4	93	144	57	877
603974	24	105	44	46.5	240	4	93	144	57	1085
603975	27	105	44	48.35	240	4	93	144	57	1085
609400	28	105	44	49	260	4	93	144	57	1165

 	Опаковка за търговия на дребно						Транспортна опаковка			
	А	Б	Ц				А1	Б1	Ц1	
603976	30	105	44	50	264	4	93	144	57	1181
605548	32	105	44	51	77	4	93	144	57	433
618709	5/16"	105	44	43	77	4	93	144	57	433
618710	3/8"	105	44	43	77	4	93	144	57	433
618711	7/16"	105	44	43	77	4	93	144	57	433
618712	1/2"	105	44	43	74	4	93	144	57	421
618713	9/16"	105	44	43	88	4	93	144	57	477
618714	5/8"	105	44	43	94	4	93	144	57	501
618715	11/16"	105	44	43	100	4	93	144	57	525
618716	3/4"	105	44	43	113	4	93	144	57	577
618717	13/16"	105	44	44	134	4	93	144	57	661
618718	7/8"	105	44	45	150	4	93	144	57	725
618719	15/16"	105	44	46	170	4	93	144	57	805
618720	1"	105	44	47	188	4	93	144	57	877
618721	1.1/16"	105	44	48	220	4	93	144	57	1005
618722	1.1/8"	105	44	49	231	4	93	144	57	1049
618723	1.3/16"	105	44	50	246	4	93	144	57	1109
618724	1.1/4"	105	44	51	253	4	93	144	57	1137
618725	1.5/16"	175	80	45	276	1	-	-	-	-
618726	1.3/8"	175	80	48,5	333	1	-	-	-	-
618727	1.7/16"	175	80	50,5	374	1	-	-	-	-
618728	1.1/2"	175	80	52,5	376	1	-	-	-	-

Ташев-Галвинг ООД
www.tashev-galving.com